

Duke University Medical Center Regional Map

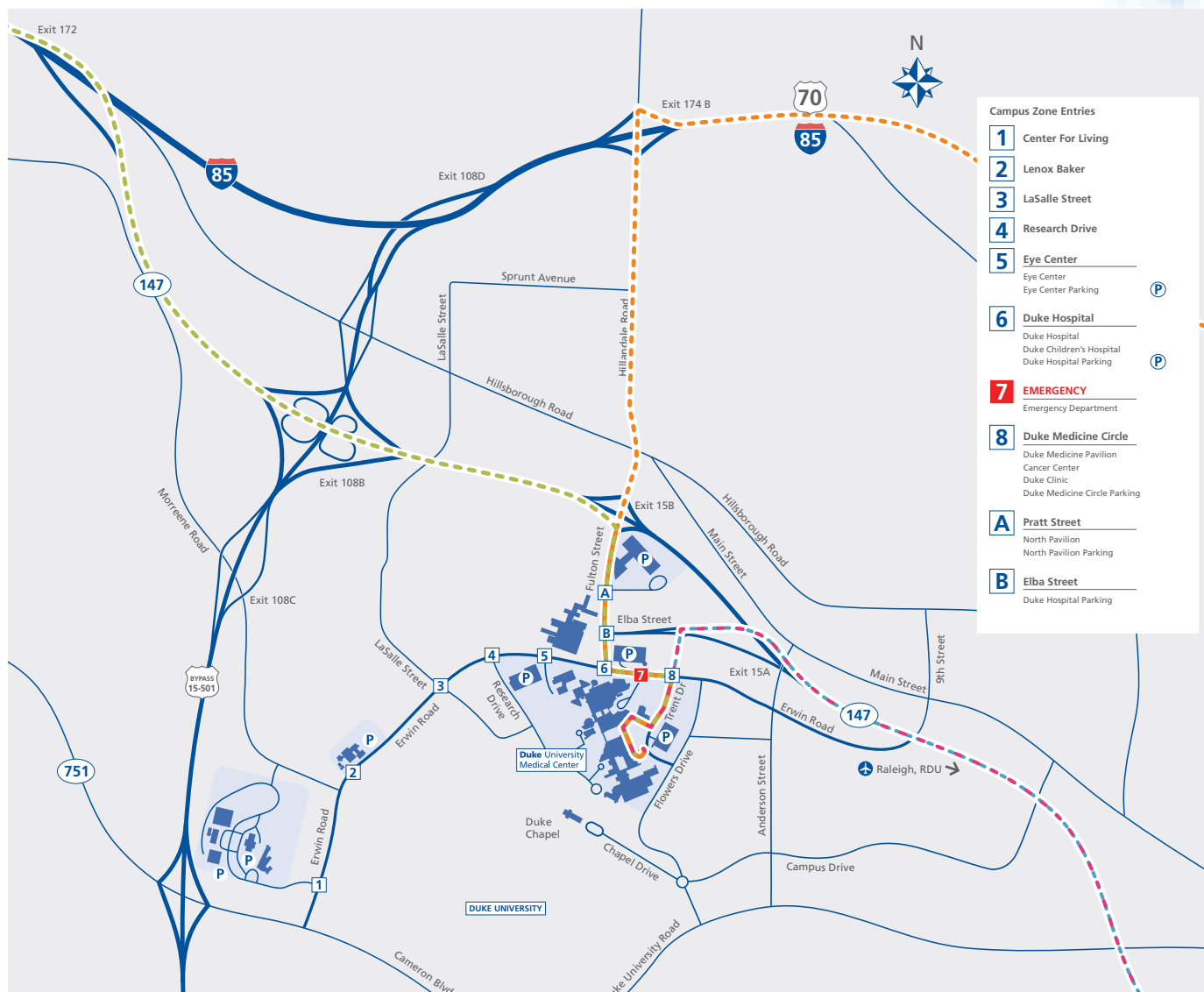

Directions to Duke Medicine Circle

From Richmond and points north

- From I-85, take Exit 174B—Hillandale Road. Turn left onto Hillandale Road.
- Drive 1.5 miles south and continue without turning as Hillandale Road becomes Fulton Street.
- Turn left onto Erwin Road.
- Turn right onto Trent Drive. You will see signs referencing Zone 8.
- Trent Drive becomes Duke Medicine Circle.
- The Duke Medicine Circle parking garage is located at 302 Trent Drive, about 1/10 mile after you make the turn onto Trent Drive.

From RDU Airport, Raleigh, and points east

- From I-40, take Exit 279B—NC 147 North.
- From NC 147, take Exit 15A—Elba Street/Trent Drive.
- At the top of the ramp, turn left onto Trent Drive. You will see signs referencing Zone 8.
- Trent Drive becomes Duke Medicine Circle.
- The Duke Medicine Circle parking garage is located at 302 Trent Drive, about 1/10 mile after you make the turn onto Trent Drive.

From Fayetteville and points south

- From I-95 N, take Exit 81—1-40 W toward Raleigh.
- Take Exit 279B to merge onto NC 147 N toward Durham.
- From NC 147, take Exit 15A for Elba Street/Trent Drive.
- At the top of the ramp, turn left onto Trent Drive. You will see signs referencing Zone 8.
- Trent Drive becomes Duke Medicine Circle.
- The Duke Medicine Circle parking garage is located at 302 Trent Drive, about 1/10 mile after you make the turn onto Trent Drive.

Duke University Medical Center Campus Map

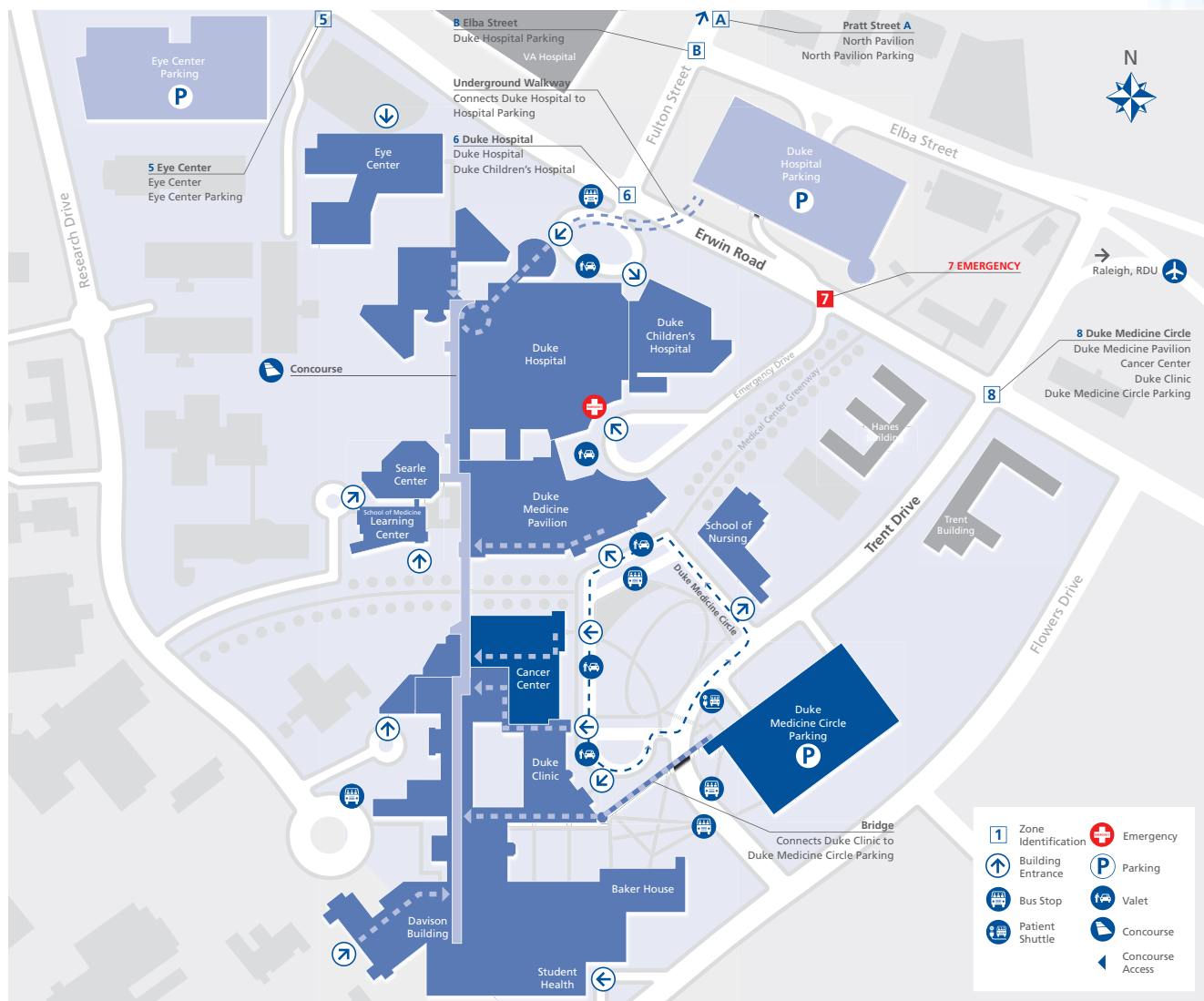

Directions to Duke Medicine Circle

From Greensboro and points west

- From I-85, take Exit 172—NC 147 South.
- From NC 147, take Exit 15B—Fulton Street. Turn right onto Fulton Street.
- Turn left onto Erwin Road.
- Turn right onto Trent Drive. You will see signs referencing Zone 8.
- Trent Drive becomes Duke Medicine Circle.
- The Duke Medicine Circle parking garage is located at 302 Trent Drive, about 1/10 mile after you make the turn onto Trent Drive.

P Parking is available in the Duke Medicine Circle parking garage located at 302 Trent Drive for \$1 per hour or \$6 for the entire day (fees subject to change). A book of 10 daily parking passes is available for \$25 (fee subject to change) in all gift shops. Handicapped parking is available in the garage. A patient shuttle is located just outside the garage to provide free rides for you and your family to the main entrance.

Valet parking is available at the main entrance for \$7 (fees subject to change). You will be greeted at your car and receive a claim check for your vehicle, and your car will be parked in the parking garage.

Wheelchairs and assistance are available in at the main entrances of the clinic and hospital.

Call to make an appointment.

Patients: **888-275-DUKE**

Physicians: **800-MED-DUKE**